

MEDLEY VIEW II

LED LINEAR LIGHTING

FACADE | FLOOD | ACCENT



INSIGHT



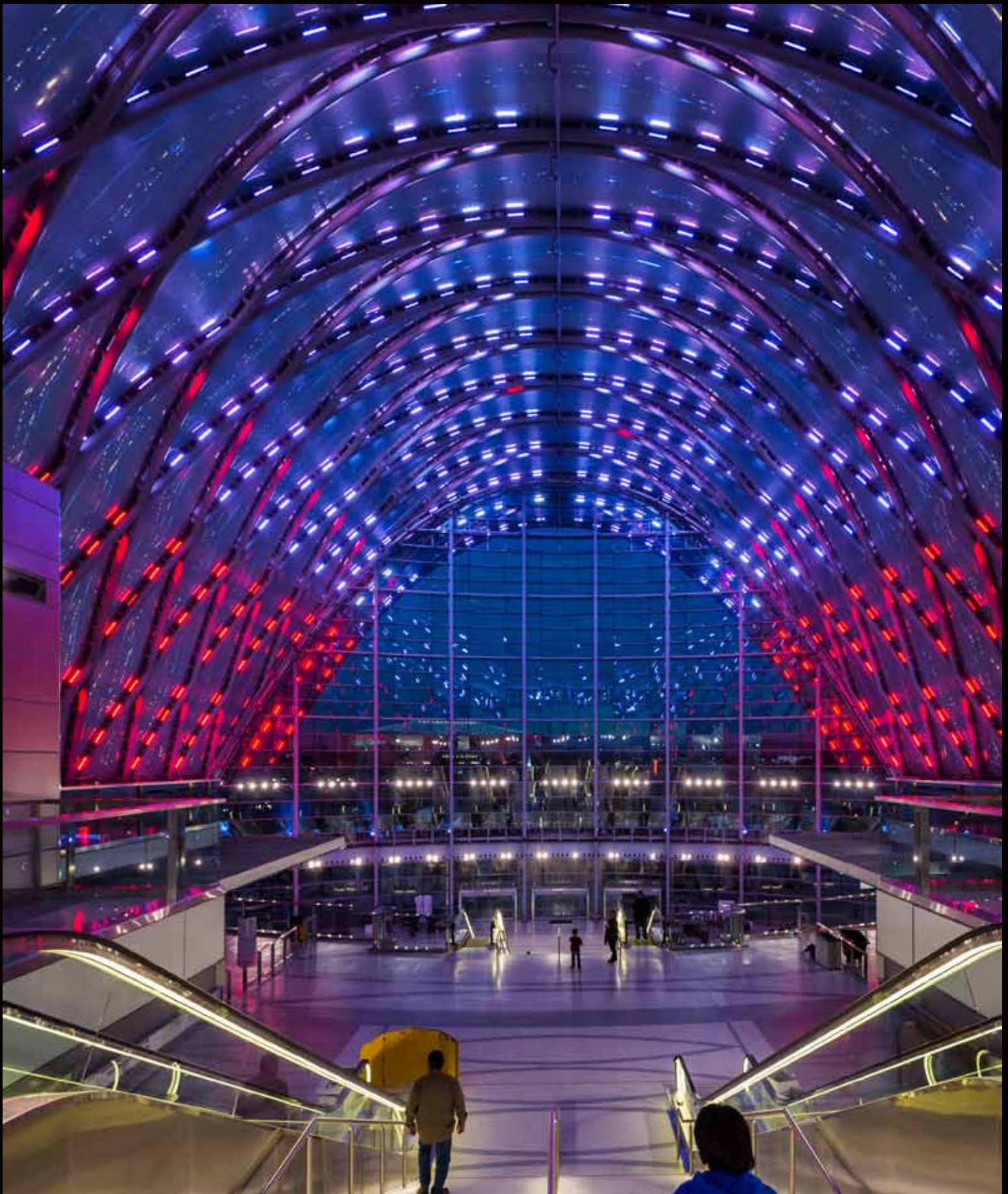

▲ Anaheim Regional Transportation Intermodal Center
Architect: HOK
Lighting Designer: HLB Lighting Design
Photographer: Rick Horn Studio

MEDLEY VIEW II

LED LINEAR LIGHTING
FACADE | FLOOD | ACCENT



PRODUCT
SPECIFICATIONS

11

ORDERING
INFORMATION

12-13

MOUNTING &
DIMENSIONS

14-15



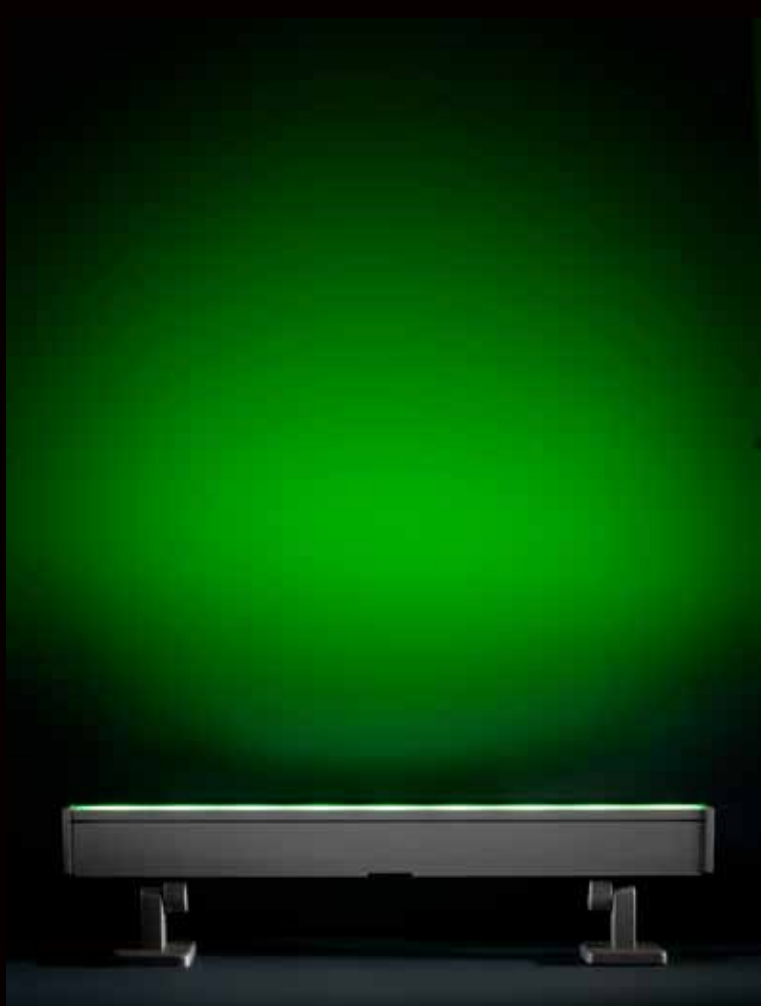

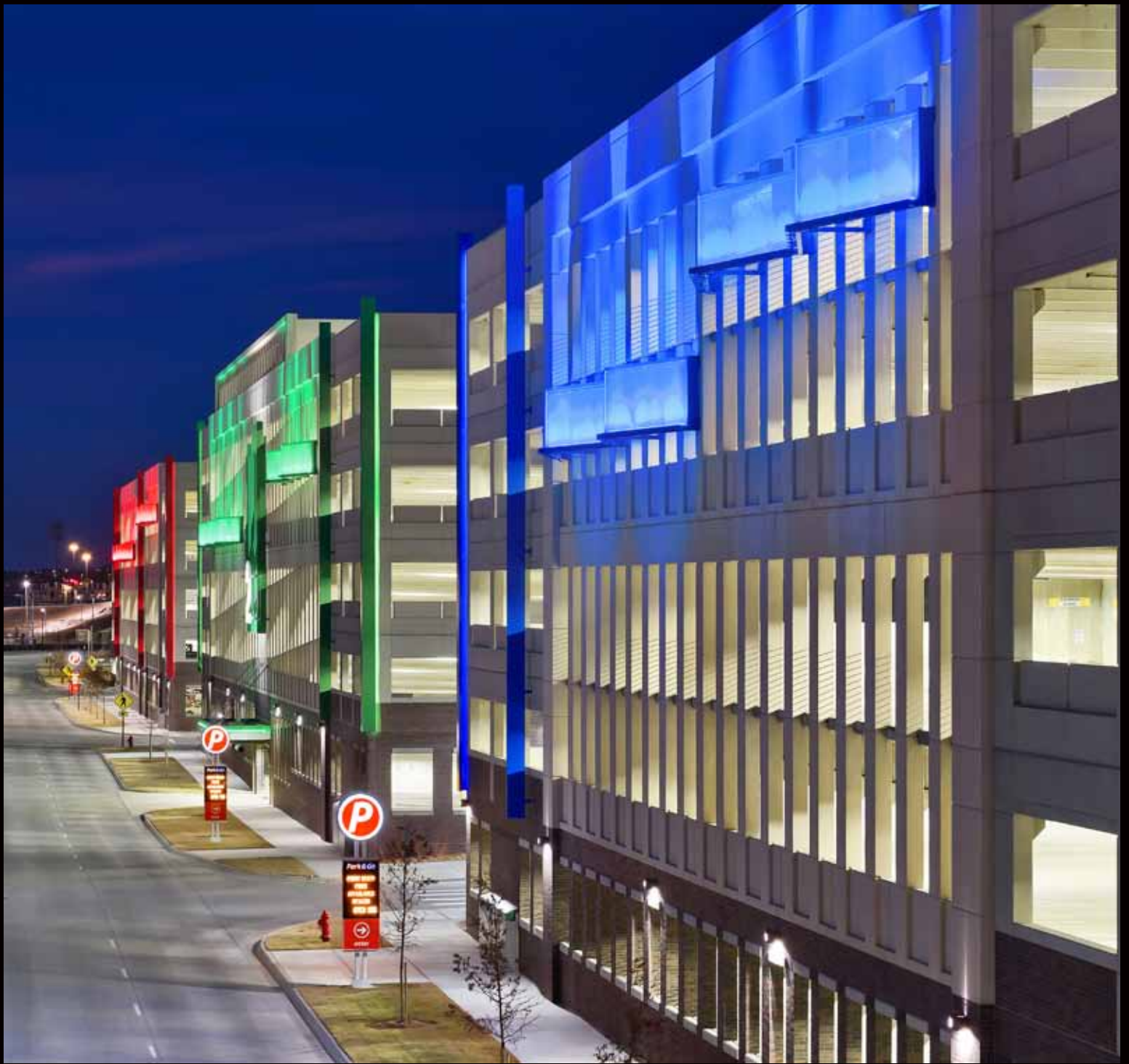

▲ West Haymarket Parking Decks - Lincoln, NE
Architect: Davis Design
Photography: Ken Petersen, Petersen Photography



▲ OSU Gateway Tower at Oklahoma State University
Architect: Kinslow, Keith & Todd, Inc
Photography: Josh New



◀ CWD Trust Building - Grand Rapids, MI
Design/Build Contractor: Feyen Zylstra
Lighting Designers: Heather Libonati, LC
Luminesce Design Inc
Photography: M-Buck Studio LLC

◀ Crown Plaza - Pittsburgh, PA
Architect: Keith Andreyko - Integrity Design, Bridgeville, PA
Photography: Courtesy of IHG





Blue Bridge - Grand Rapids, MI
Design Firm: Fishbeck Thompson Carr & Huber
Lighting Designer: Michigan Lighting Systems
Photography: Cory Morse





MEDLEY VIEW II

LED LINEAR LIGHTING

FACADE | FLOOD | ACCENT

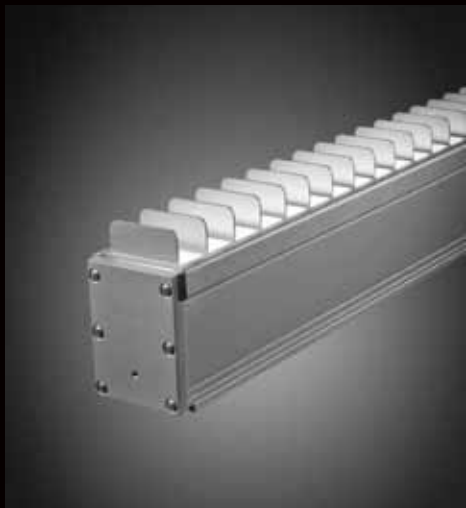

INSIGHT

www.insightlighting.com

	SPECIFICATION					
LIGHT SOURCE	3.5W/FT, 6W/FT, 12W/FT, 17W/FT					
BEAM ANGLES	7°, 15°, 30°, 45°, 100°					
COLOR TEMPERATURES	2700 K, 3500 K, 4000 K, Active White (27K, 40K, 65K), Static Red, Static Green, Static Blue, Static Amber RGB, RGBW, RGBWWA, RGB+W					
CRI	82					
OUTPUT	WHITE LIGHT (4000K) (4 foot fixture)					
		FIXTURE WATTAGE (TOTAL WATTAGE)	OPTICS	LUMENS	EFFICACY	MAX CANDELA
	- TOTAL POWER CONSUMPTION (W/ft)	3.5 (4.1 W/ft)	7°	1079	66 lm/W	12011
	- LUMENS	3.5 (4.1 W/ft)	15°	971	60 lm/W	6202
	- EFFICACY (lm/W)	3.5 (4.1 W/ft)	30°	987	61 lm/W	3559
	- MAX CANDELA (CD / m ²)	3.5 (4.1 W/ft)	45°	925	57 lm/W	1423
	(3.5W/ft fixture meets current ASHRAE requirements)	6 (7.4 W/ft)	7°	1650	56 lm/W	19283
		6 (7.4 W/ft)	15°	1489	50 lm/W	9518
		6 (7.4 W/ft)	30°	1515	51 lm/W	5461
		6 (7.4 W/ft)	45°	1419	48 lm/W	2184
		6 (7.9 W/ft)	100°	2433	77 lm/W	880
		12 (14.2 W/ft)	7°	3272	54 lm/W	38245
		12 (14.2 W/ft)	15°	2954	52 lm/W	18877
		12 (14.2 W/ft)	30°	3004	53 lm/W	10832
		12 (14.2 W/ft)	45°	2814	50 lm/W	4332
		12 (16.4 W/ft)	100°	4592	70 lm/W	1706
17 (21.3 W/ft)		7°	4674	55 lm/W	54636	
17 (21.3 W/ft)		15°	4220	50 lm/W	26968	
17 (21.3 W/ft)		30°	4292	51 lm/W	15475	
17 (21.3 W/ft)		45°	4020	48 lm/W	6189	
LUMEN MAINTENANCE		White: 75,000 hrs L70				
ELECTRICAL	AC LINE VOLTAGE	120V OR 277V				
	POWER SUPPLY	INTEGRAL TO THE LUMINAIRE				
CONTROL	0-10V & DMX					
PHYSICAL	HOUSING	Aluminum extrusion with cast aluminum end caps, powder-coat finish				
	DIMENSIONS	HEIGHT X WIDTH X LENGTH: 3-7/8" X 2-3/4" X 12" / 24" / 36" / 48"				
	LENS	Tempered glass				
	OPERATING TEMPERATURE	-20° C to 40° C				
CERTIFICATION	CERTIFICATION	ETL approved for wet locations (pending)				
WARRANTY	5 YEAR	Limited				

All MEDLEY® products are tested to IES LM-79, LM-80 and ANSI C78.377A standards

OPTICS

White Light (27K, 35K, 40K) Optics

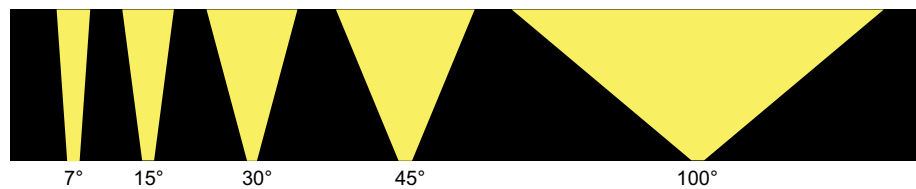

RGB & RGBW Color Changing Optics

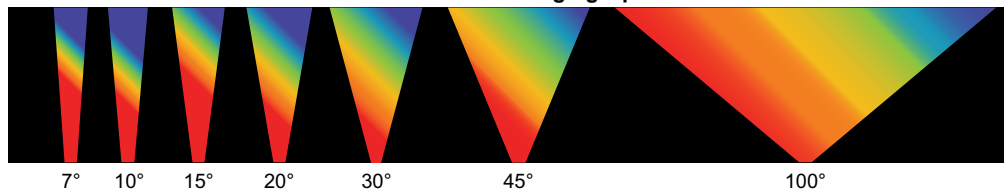

SELECT FIXTURE																																																																																																																																																																																														
PREFIX	WATTAGE WATTS /FT	COLOR TEMPS OR COLORS	OPTICS	MOUNTING OPTIONS	FIXTURE LENGTH	VOLTAGE/ WIRING METHOD	CONTROLS	FINISH	OPTIONS																																																																																																																																																																																					
MWWII MEDLEY VIEW II	STATIC WHITE LIGHT			CONCEALED WIRE MOUNTING OPTIONS SMSCW = Surface EASCW6 = 6" Extended Arm EASCW12 = 12" Extended Arm EASCW18 = 18" Extended Arm CDSCW = Conduit Mount	12" 24" 36" 48"	INT1 = 120V integral power INT2 = 277V power supply ACV1 = 120V feed thru wiring for end-to-end fixture connection * ACV2 = 277V feed thru wiring for end-to-end fixture connection *	ACTIVE WHITE CONTROLS DMX = DMX control protocol # # Active white color changing requires a DMX programmer for proper mixing. Must order separately. CONTACT FACTORY FOR DIMMING OPTIONS	TW = Textured White TBL = Textured Black TBR = Textured Bronze TN = Textured Natural TS = Textured Sandstone CC = Custom Color # # Contact factory, additional charges will apply	VS = Visor ** LV = Louver ** ** Visor & Louver are field installable and cannot be combined. See page 10 for details. WL = White diffusing lens (to be used with 100° optics only) CRF = Corrosion Resistant Finish Corrosion Resistant Finish is recommended for coastal or extreme exterior environments	3.5	27K	7°	6	35K	15°	12	40K	30°			45°	3.5 W/ft meets current ASHRAE requirements										ASY = Asymmetric Distribution										17	27K	7°									35K	15°									40K	30°										45°								STATIC COLORS			EXPOSED WIRE MOUNTING OPTIONS 12" fixtures are not available with exposed wire mounting options SMS = Surface Mount EAS6 = 6" Extended Arm EAS12 = 12" Extended Arm EAS18 = 18" Extended Arm	24" 36" 48"	INT1 = 120V integral power INT2 = 277V power supply ACV1 = 120V feed thru wiring for end-to-end fixture connection * ACV2 = 277V feed thru wiring for end-to-end fixture connection *	Exposed wire mounting options with ACV1, ACV2 require an AC jumper cable at the beginning of a fixture run. See below. Load not to exceed 16 amps for all wiring methods				3.5	R = Red G = Green B = Blue A = Amber	7°	6		15°	12		30°								17		45°										100°								ACTIVE WHITE (TUNEABLE WHITE)			FMS = Fixed Mount CDS = Conduit Mount	12" fixtures are not available with exposed wire mounting options	ACV1 = 120V feed thru wiring for end-to-end fixture connection * ACV2 = 277V feed thru wiring for end-to-end fixture connection *					17	AWH = Color changing white light ranging from 27K, 40K, 65K #	7°			15°										30°										45°										100°								• Active White Light requires a DMX programmer for proper mixing. Must order separately # • For DMX controls, please refer to www.insightlighting.com/products.php?family=LED%20Controls • One DMX Distribution/Programming Kit (CDS-PK) must be ordered for each ACTIVE WHITE installation. See below.									
	3.5	27K	7°																																																																																																																																																																																											
	6	35K	15°																																																																																																																																																																																											
	12	40K	30°																																																																																																																																																																																											
			45°																																																																																																																																																																																											
	3.5 W/ft meets current ASHRAE requirements																																																																																																																																																																																													
	ASY = Asymmetric Distribution																																																																																																																																																																																													
	17	27K	7°																																																																																																																																																																																											
		35K	15°																																																																																																																																																																																											
		40K	30°																																																																																																																																																																																											
		45°																																																																																																																																																																																												
STATIC COLORS			EXPOSED WIRE MOUNTING OPTIONS 12" fixtures are not available with exposed wire mounting options SMS = Surface Mount EAS6 = 6" Extended Arm EAS12 = 12" Extended Arm EAS18 = 18" Extended Arm	24" 36" 48"	INT1 = 120V integral power INT2 = 277V power supply ACV1 = 120V feed thru wiring for end-to-end fixture connection * ACV2 = 277V feed thru wiring for end-to-end fixture connection *	Exposed wire mounting options with ACV1, ACV2 require an AC jumper cable at the beginning of a fixture run. See below. Load not to exceed 16 amps for all wiring methods																																																																																																																																																																																								
3.5	R = Red G = Green B = Blue A = Amber	7°																																																																																																																																																																																												
6		15°																																																																																																																																																																																												
12		30°																																																																																																																																																																																												
17		45°																																																																																																																																																																																												
		100°																																																																																																																																																																																												
ACTIVE WHITE (TUNEABLE WHITE)			FMS = Fixed Mount CDS = Conduit Mount	12" fixtures are not available with exposed wire mounting options	ACV1 = 120V feed thru wiring for end-to-end fixture connection * ACV2 = 277V feed thru wiring for end-to-end fixture connection *																																																																																																																																																																																									
17	AWH = Color changing white light ranging from 27K, 40K, 65K #	7°																																																																																																																																																																																												
		15°																																																																																																																																																																																												
		30°																																																																																																																																																																																												
		45°																																																																																																																																																																																												
		100°																																																																																																																																																																																												
• Active White Light requires a DMX programmer for proper mixing. Must order separately # • For DMX controls, please refer to www.insightlighting.com/products.php?family=LED%20Controls • One DMX Distribution/Programming Kit (CDS-PK) must be ordered for each ACTIVE WHITE installation. See below.																																																																																																																																																																																														

DMX DISTRIBUTION & PROGRAMMING KIT - REQUIRED FOR ALL COLOR CHANGING AND ACTIVE WHITE LIGHT & COLOR CHANGING INSTALLATIONS

CATALOG NUMBER	DESCRIPTION
CDS-PK	DMX DISTRIBUTION & PROGRAMMING KIT One CDS-PK is required per RGB installation. CDS-PK consists of four outputs. Each output accommodates up to 32 fixtures in INT/REM wiring methods and unlimited fixtures in ACV wiring method (every universe requires its own dedicated CDS-PK). The CDS-PK includes a LED programming kit for field addressing. If additional splitters are required, order CDS-A per project requirements.
CDS-A	DMX DISTRIBUTION KIT ONLY (3 OUTPUTS) CDS-A consists of three outputs. Each output accommodates up to 32 fixtures in INT/REM wiring methods and unlimited fixtures in ACV wiring method.

For installation guidelines, please refer to the CDS DMX Splitter specification sheet: www.insightlighting.com/pdfs/specs/CDS%20Spec%20Sheet.pdf

JUMPER CABLES - ORDER SEPARATELY

ACV WIRING METHOD WITH EXPOSED WIRE MOUNTING OPTIONS
 • An AC Jumper is required with each fixture run for connection from fixture to j-box.
 • ACV WIRING METHOD allows for end-to-end fixture connection without additional jumpers. If fixtures are not mounted in an end-to-end continuous manner, AC jumpers are required.

CATALOG NUMBER	DESCRIPTION	CATALOG NUMBER	DESCRIPTION
ACJ-2	2' AC POWER/DATA JUMPER CABLE	ACJ-10	10' AC POWER/DATA JUMPER CABLE
ACJ-5	5' AC POWER/DATA JUMPER CABLE	ACJ-25	25' AC POWER/DATA JUMPER CABLE

SELECT FIXTURE									
PREFIX	WATTS /FT	COLORS	OPTICS	MOUNTING OPTION	FIXTURE LENGTH	VOLTAGE/ WIRING METHOD	CONTROLS	FINISH	OPTIONS
MWVII MEDLEY VIEW II	RGB COLOR CHANGING			CONCEALED WIRE MOUNTINGS SMSCW = Surface EASCW6 = 6" Extended Arm EASCW12 = 12" Extended Arm EASCW18 = 18" Extended Arm CDSCW = Conduit Mount	12" 24" 36" 48"	INT1 = 120V integral power INT2 = 277V power supply ACV1 = 120V feed thru wiring for end-to-end fixture connection * ACV2 = 277V feed thru wiring for end-to-end fixture connection *	DMX = DMX control # protocol # All color changing products require a DMX controller for proper mixing. Must order separately.	TW Textured White TBL Textured Black TBR Textured Bronze TN Textured Natural TS Textured Sandstone CC Custom Color # # Contact factory, additional charges will apply	VS = Visor ** LV = Louver ** ** Visor & Louver are field installable and cannot be combined. See page 10 for details. WL = White diffusing lens (to be used with 100° optics only) CRF = Corrosion Resistant Finish Corrosion Resistant Finish is recommended for coastal or extreme exterior environments
	6	RGB Tricolor	100°						
	6W RGB (tri-color): red, green & blue (fixture control only)								
	12	RGB Tricolor	12° 20° 100°						
	9W RGB (tri-color): red, green & blue								
	17	RGB Discreet	7° 15° 30° 45° 100°						
	17W RGB (discreet): red, green & blue color changing								
	RGB+W COLOR CHANGING			EXPOSED WIRE MOUNTINGS SMS = Surface Mount EAS6 = 6" Extended Arm EAS12 = 12" Extended Arm EAS18 = 18" Extended Arm FMS = Fixed Mount CDS = Conduit Mount	24" 36" 48"	INT1 = 120V integral power INT2 = 277V power supply ACV1 = 120V feed thru wiring for end-to-end fixture connection * ACV2 = 277V feed thru wiring for end-to-end fixture connection * Exposed wire mounting options with ACV1, ACV2 require an AC jumper cable at the beginning of a fixture run. See below.	12" fixtures are not available with exposed wire mounting options For multiple fixture runs, specify nominal run length in feet	Load not to exceed 16 amps for all wiring methods	
	12	RGB+W Tricolor	100°						
	12W RGB (tri-color) + W: red, green, blue + 40K white (fixture control only)								
	RGBW COLOR CHANGING								
	17	RGBWd Discreet	7° 15° 30° 45° 100°						
	17W RGBWd (discreet): red, green, blue, 57K white								
	17	RGBW Quad-color	10° 30° 100°						
	17W RGBW (quad-color): red, green, blue, 40K white								
	RGBWWA COLOR CHANGING								
	15	RGBWWA Discreet	18° 42° 100°						
	RGBWWA (discreet): red, green, blue, 35K white, 65K white & amber								
<ul style="list-style-type: none"> # All color changing products require a DMX programmer for proper mixing. Must order separately. For DMX controls, please refer to www.insightlighting.com/products.php?family=LED%20Controls One DMX Distribution/Programming Kit (CDS-PK) must be ordered for each RGB, RGB+W, RGBW and RGBWWA installation. See See PAGE 10. Every fixture is shipped standard as System Addressing. (Every fixture has the same address.) 									

DMX DISTRIBUTION & PROGRAMMING KIT - REQUIRED FOR ALL COLOR CHANGING AND ACTIVE WHITE LIGHT & COLOR CHANGING INSTALLATIONS

CATALOG NUMBER	DESCRIPTION
CDS-PK	DMX DISTRIBUTION & PROGRAMMING KIT One CDS-PK is required per RGB installation. CDS-PK consists of four outputs. Each output accommodates up to 32 fixtures in INT/REM wiring methods and unlimited fixtures in ACV wiring method (every universe requires its own dedicated CDS-PK). The CDS-PK includes a LED programming kit for field addressing. If additional splitters are required, order CDS-A per project requirements.
CDS-A	DMX DISTRIBUTION KIT ONLY (3 OUTPUTS) CDS-A consists of three outputs. Each output accommodates up to 32 fixtures in INT/REM wiring methods and unlimited fixtures in ACV wiring method.

For installation guidelines, please refer to the CDS DMX Splitter specification sheet: www.insightlighting.com/pdfs/specs/CDS%20Spec%20Sheet.pdf

JUMPER CABLES - ORDER SEPARATELY

ACV WIRING METHOD WITH EXPOSED WIRE MOUNTING OPTIONS

- An AC Jumper is required with each fixture run for connection from fixture to j-box.
- ACV WIRING METHOD allows for end-to-end fixture connection without additional jumpers. If fixtures are not mounted in an end-to-end continuous manner, AC jumpers are required.

CATALOG NUMBER	DESCRIPTION	CATALOG NUMBER	DESCRIPTION
ACJ-2	2' AC POWER/DATA JUMPER CABLE	ACJ-10	10' AC POWER/DATA JUMPER CABLE
ACJ-5	5' AC POWER/DATA JUMPER CABLE	ACJ-25	25' AC POWER/DATA JUMPER CABLE

SMSCW - SURFACE MOUNT, SINGLE FIXTURE, CONCEALED WIRE - INT1, INT2

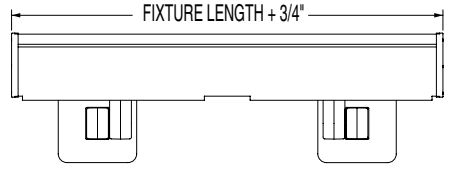
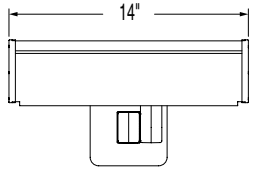
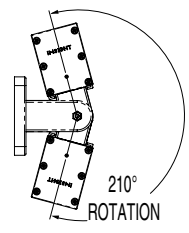
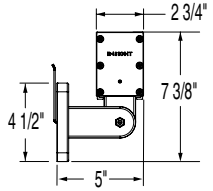

12" FIXTURES - INT1, INT2

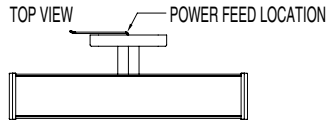

24" - 48" FIXTURES - INT1, INT2

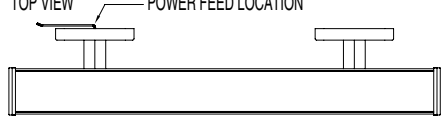

12" FIXTURES - ACV1, ACV2

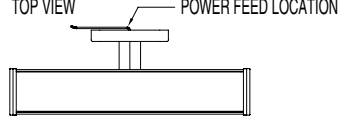

24" - 48" FIXTURES - ACV1, ACV2

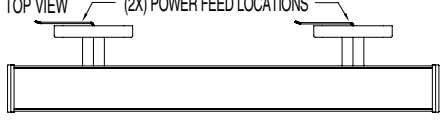

EASCW-6, 12, 18 - EXTENDED ARM (6", 12", 18"), CONCEALED WIRE - INT1, INT2

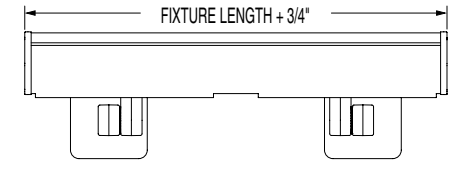
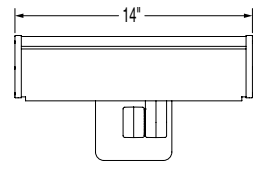
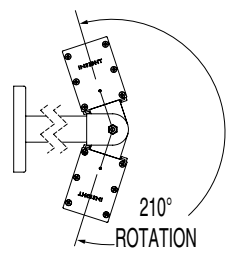
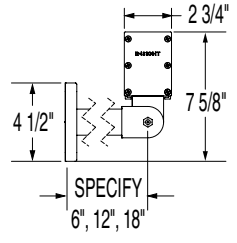

12" FIXTURES - INT1, INT2

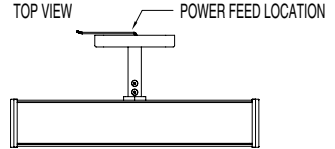

24" - 48" FIXTURES - INT1, INT2

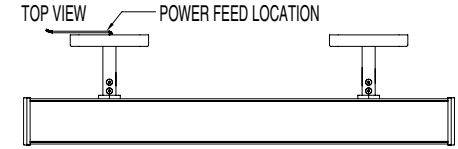

12" FIXTURES - ACV1, ACV2

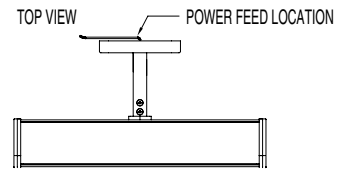

24" - 48" FIXTURES - ACV1, ACV2

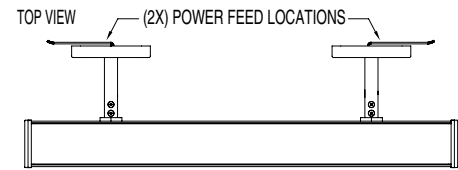

CDSCW - CONDUIT MOUNT, CONCEALED WIRE

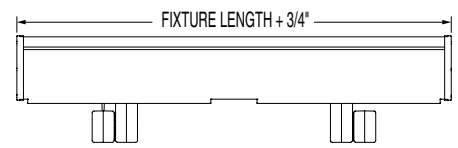
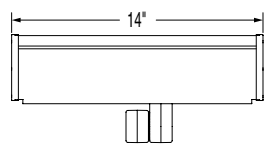
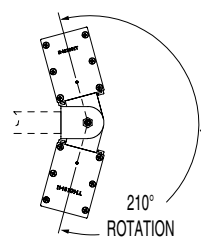
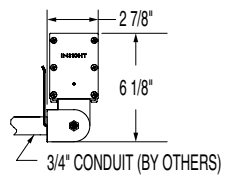

12" FIXTURES - INT1, INT2

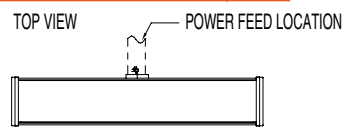

24" - 48" FIXTURES - INT1, INT2

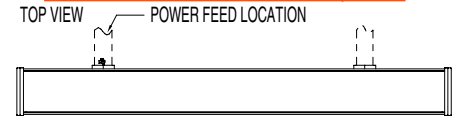

12" FIXTURES - ACV1, ACV2

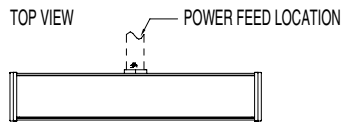

24" - 48" FIXTURES - ACV1, ACV2

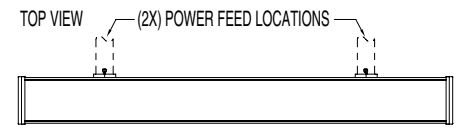

SMS - SURFACE MOUNT, SINGLE FIXTURE, EXPOSED WIRE - INT1, INT2

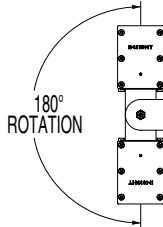
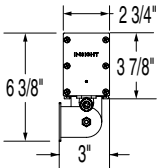
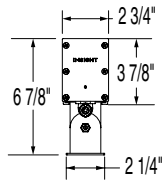

INT1, INT2

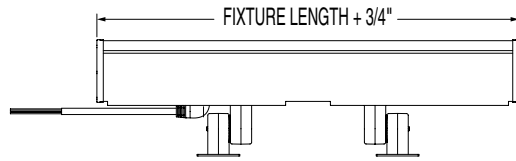

ACV1, ACV2

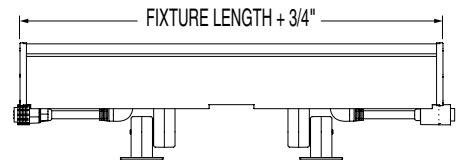

EAS-6, 12, 18 - EXTENDED ARM (6", 12", 18"), EXPOSED WIRE - INT1, INT2

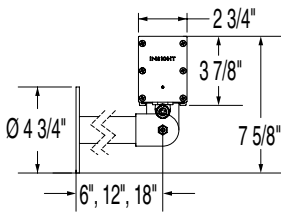

INT1, INT2

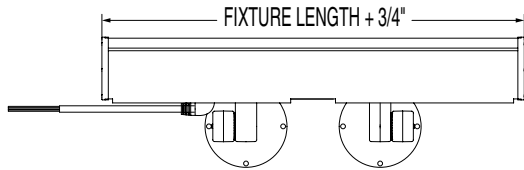

ACV1, ACV2

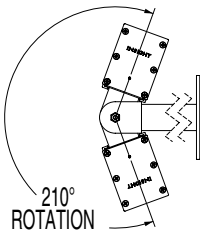
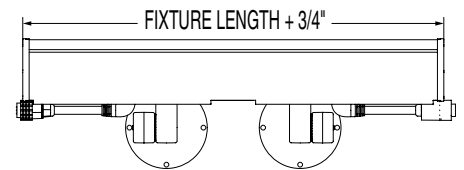

FMS - FIXED MOUNT, EXPOSED WIRE

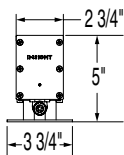

INT1, INT2

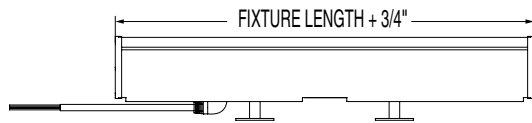

ACV1, ACV2

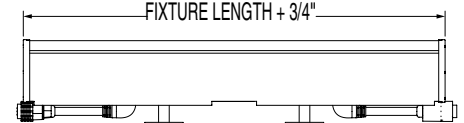

FMS - FIXED MOUNT, EXPOSED WIRE

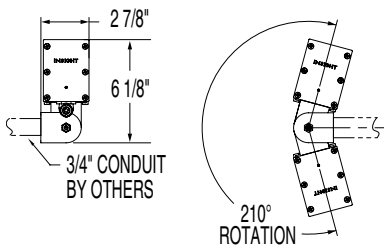

INT1, INT2

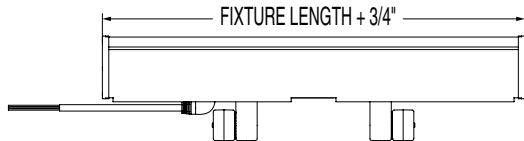

ACV1, ACV2

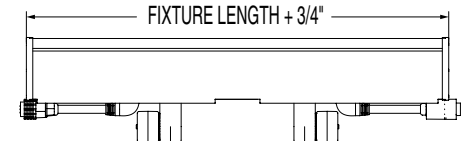

MEDLEY VIEW II

LED LINEAR LIGHTING
FACADE | FLOOD | ACCENT

Insight Lighting

4341 Fulcrum Way NE
Rio Rancho, NM 87144
Tel: 505-345-0888
www.insightlighting.com

MEDLEY_04-24-15

INSIGHT

